

Lot 100j

Parking Space Count:

| | |
|---------------------|-----|
| Regular: | 641 |
| Reserved: | 0 |
| DVS: | 4 |
| Visitor: | 0 |
| Accessible: | 46 |
| Visitor Accessible: | 0 |
| Timed: | 4 |
| Service: | 0 |
| U.B.: | 0 |
| Motorcycle: | 9 |
| Loading: | 2 |
| Other: | 0 |
| RV: | 0 |

Total: 706

Lost to (Currently Under)
Construction: 39

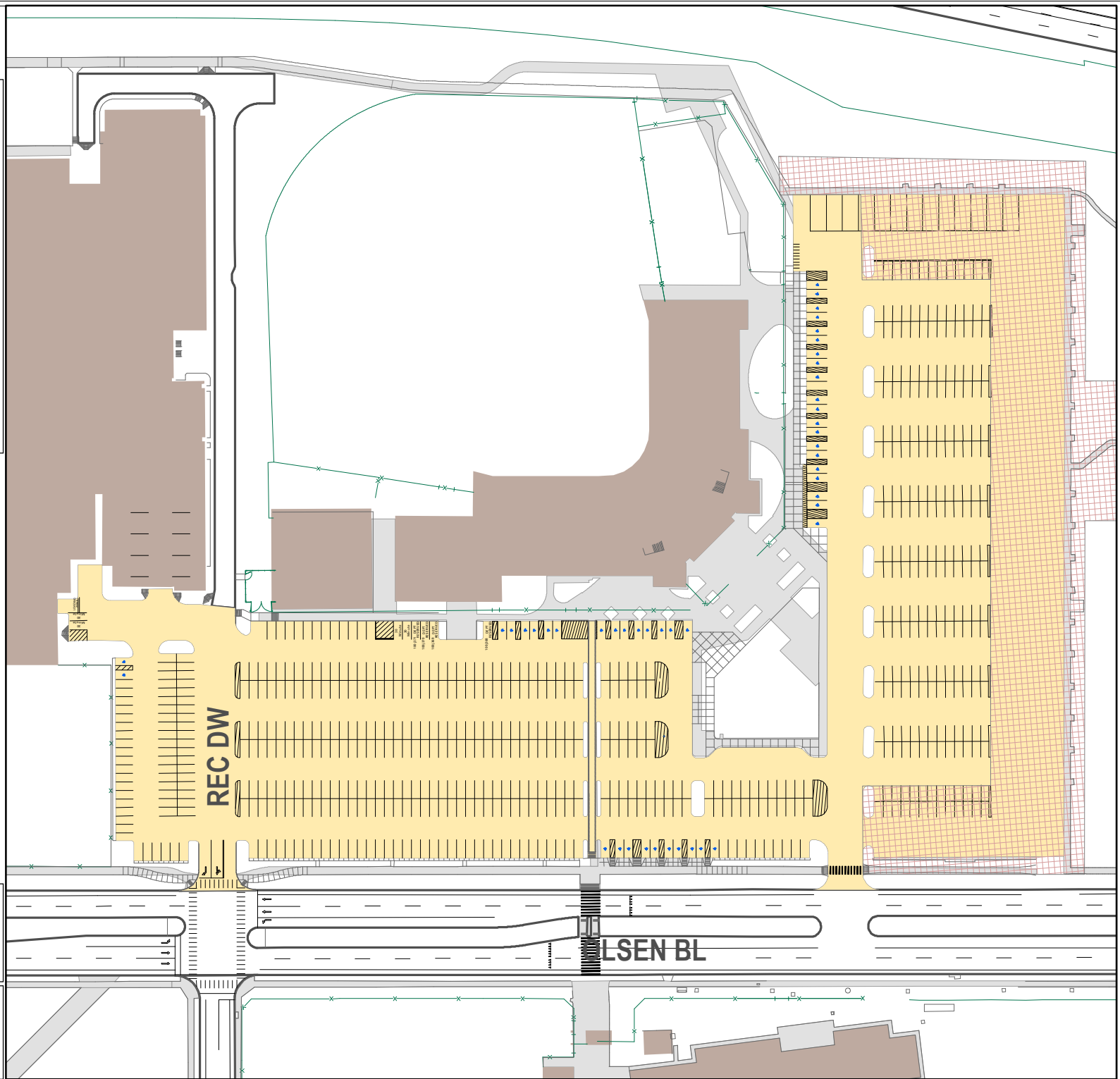

150 Feet